

# Who's Where

WHITE HOUSE CLOUT is measured not by how big an office is, but by how close it is to the Oval Office—except that Laura Bush's office is in the East Wing, on the opposite side of the residence from her husband's. The West Wing was built in 1902 under President Theodore Roosevelt, with President William Howard Taft choosing an oval shape for his office in 1909. The East Wing was added in 1942.

Here's a map of the bigwigs.

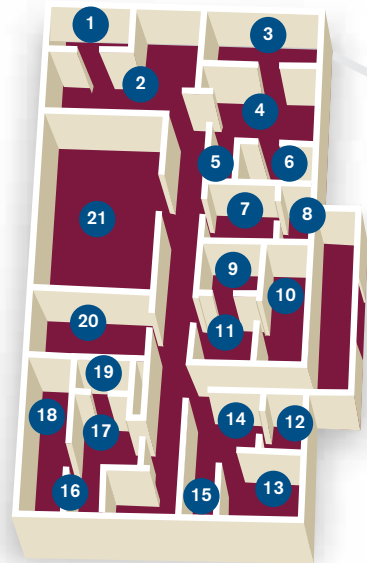

East Wing, Second Floor

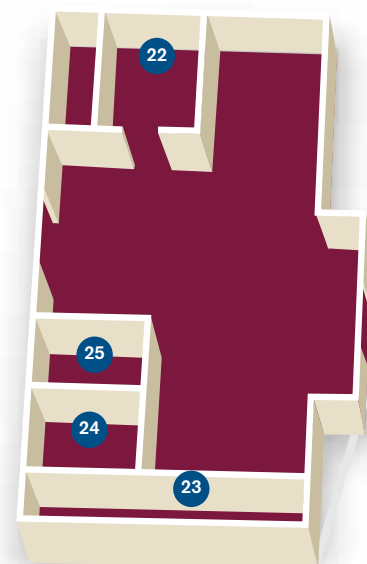

East Wing, First Floor

## EAST WING, SECOND FLOOR

- |                                                          |                                           |
|----------------------------------------------------------|-------------------------------------------|
| 1. Misty Marshall, Director, First Lady's Correspondence | 14. Assistant                             |
| 2. Assistants                                            | 15. Charity Wallace, Advance Director     |
| 3. Mrs. Bush's office                                    | 16. Calligraphers                         |
| 4. Assistants                                            | 17. Assistants                            |
| 5. Assistant                                             | 18. Lea Berman, Social Secretary          |
| 6. Sonya Medina, Projects Director                       | 19. Missy DeCamp, Deputy Social Secretary |
| 7. Maria Miller, Deputy Projects Director                | 20. Supplies                              |
| 8. Ed Walsh, Mrs. Bush's Speechwriter                    | 21. White House Military Office           |
| 9. Peter Watkins, Deputy Press Secretary                 |                                           |
| 10. Susan Whitson, Press Secretary                       |                                           |
| 11. Assistants                                           |                                           |
| 12. Mary Beth Farr, Scheduler                            |                                           |
| 13. Anita McBride, Chief of Staff                        |                                           |

## EAST WING, FIRST FLOOR

- |                                  |
|----------------------------------|
| 22. Legislative Affairs          |
| 23. White House Visitors' Office |
| 24. Military Aide                |
| 25. East Wing Reception Room     |



LIZ LYNCH

## WEST WING, FIRST FLOOR (CENTER RIGHT)

- |                                                                                           |                                                                                                                           |
|-------------------------------------------------------------------------------------------|---------------------------------------------------------------------------------------------------------------------------|
| 1. Blake Gottesman, Special Assistant to the President and Personal Aide                  | 23. Dan Bartlett, Counselor to the President                                                                              |
| 2. Joseph Hagin, Assistant to the President and Deputy Chief of Staff                     | 24. Allan Hubbard, Assistant to the President for Economic Policy and Director, National Economic Council                 |
| 3. Karl Rove, Assistant to the President, Deputy Chief of Staff, and Senior Adviser       | 25. Keith Hennessey, Deputy Assistant to the President for Economic Policy and Deputy Director, National Economic Council |
| 4. Andrew Card, Assistant to the President and Chief of Staff                             | 26. Bill McGurn, Assistant to the President for Speechwriting                                                             |
| 5. Dick Cheney, Vice President                                                            |                                                                                                                           |
| 6. Steve Hadley, Assistant to the President for National Security Affairs                 |                                                                                                                           |
| 7. J.D. Crouch, Assistant to the President and Deputy National Security Adviser           |                                                                                                                           |
| 8. Erin Healy, Assistant Press Secretary                                                  |                                                                                                                           |
| 9. VACANT                                                                                 |                                                                                                                           |
| 10. Scott McClellan, Assistant to the President and Press Secretary                       |                                                                                                                           |
| 11. Karen Keller, Special Assistant to the President and Personal Secretary               |                                                                                                                           |
| 12. Mike Gerson, Assistant to the President for Policy and Strategic Planning             |                                                                                                                           |
| 13. Susan Ralston, Special Assistant to the President and Assistant to the Senior Adviser |                                                                                                                           |
| 13. Steve Atkiss, Special Assistant to the President for Operations                       |                                                                                                                           |

## Lower Press Office (Not Shown)

- Trent Duffy, Deputy Assistant to the President and Deputy Press Secretary  
 Dana Perino, Special Assistant to the President and Deputy Press Secretary  
 Josh Deckard, Assistant Press Secretary

## WEST WING, GROUND FLOOR (BOTTOM RIGHT)

- |                                                                                                                                                                                                             |
|-------------------------------------------------------------------------------------------------------------------------------------------------------------------------------------------------------------|
| 27. Melissa Bennett, Deputy Assistant to the President for Appointments and Scheduling                                                                                                                      |
| 28. Brett Kavanaugh, Assistant to the President and Staff Secretary                                                                                                                                         |
| 29. Bill Burck, Deputy Assistant to the President and Deputy Staff Secretary                                                                                                                                |
| 30. Eric Draper, Director of Photography; Paul Morse, Deputy Director of Photography                                                                                                                        |
| 31. Frances Fragos Townsend, Assistant to the President for Homeland Security and Counterterrorism; Kenneth Rapuano, Deputy Assistant to the President for Homeland Security                                |
| 32. Linda Gambatesa, Deputy Assistant to the President for Management, Administration, and Oval Office Operations; Colleen Litkenhaus, Special Assistant to the President for Management and Administration |
| 33. Executive Dining Room                                                                                                                                                                                   |
| 34. White House Mess                                                                                                                                                                                        |
| 35. Situation Room                                                                                                                                                                                          |

## WEST WING, SECOND FLOOR (TOP RIGHT)

- |                                                                                             |
|---------------------------------------------------------------------------------------------|
| 14. Claude Allen, Assistant to the President for Domestic Policy                            |
| 15. Tevi Troy, Deputy Assistant to the President for Domestic Policy                        |
| 16. Kristen Silverberg, Deputy Assistant to the President and Adviser to the Chief of Staff |
| 17. Harriet Miers, Counselor to the President                                               |
| 18. Bill Kelley, Deputy Counselor to the President                                          |
| 19. Assistant to the President for Presidential Personnel                                   |
| 20. Doug Badger, Deputy Assistant to the President for Legislative Affairs                  |
| 21. Candi Wolff, Assistant to the President for Legislative Affairs                         |
| 22. Nicolle Devenish, Assistant to the President for Communications                         |

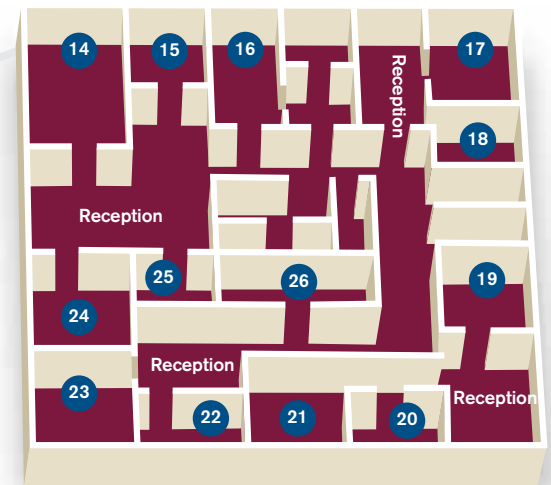

West Wing, Second Floor

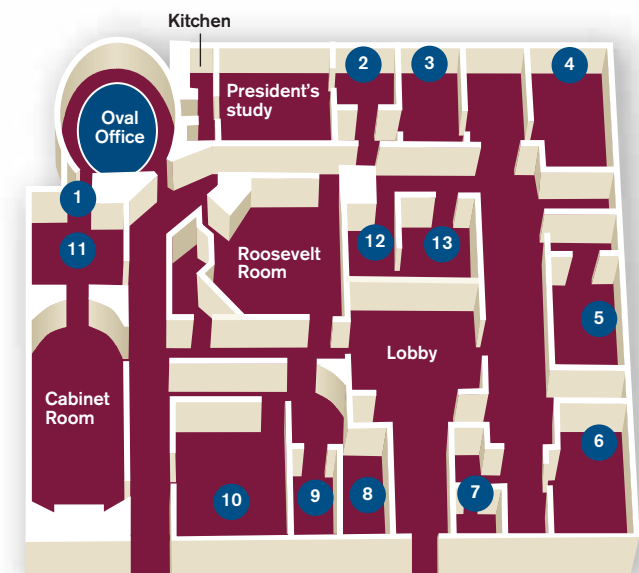

West Wing, First Floor

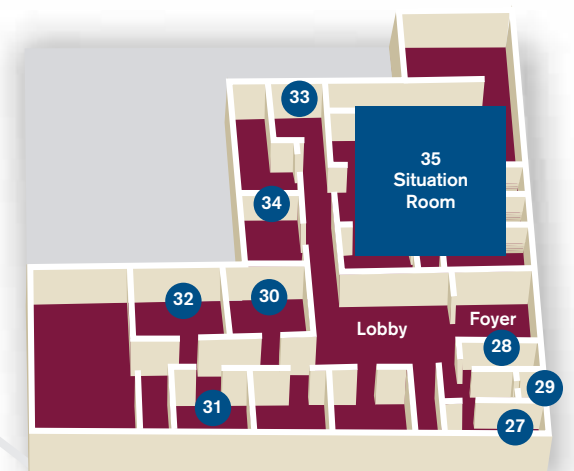

West Wing, Ground Floor

SOURCES: The White House; staff tours; Globalsecurity.org